



XLW Series

Wear-Resistant, Abrasive Liquid Pumps

Construction

Blackmer XLW ductile iron pumps are specially designed to handle liquids with suspended abrasive particles and are constructed with hardened and replaceable wear surfaces (liners and end discs) for extended service life.

Models are available in 1.25, 1.5, 2 and 3-inch port sizes with capacities from 1 to 85 gpm (4 to 330 L/min). The 1.25 and 1.5-inch models have NPT tapped ports. The 2 and 3-inch models have flanged ports with NPT, weld, ANSI and DIN options.

With available O-rings, mechanical seals, relief valves, springs, vanes and rotors, XLW pumps may be fitted to handle a wide variety of materials.

Base mounted unit assemblies with a helical gear reduction drive are available for all XLW models.

Applications

The XLW is capable of handling liquids with suspended particles up to 250 microns and 25% concentration such as oxide primers, inks, paints and adhesives. In addition, these rugged pumps are widely used on vertical and horizontal bead mills, solvent recovery and varied oil applications, including tank bottom recirculation, heat treater supply, enhanced oil recovery and crude or hot oil transfer.

Applications

Utilizing Blackmer's unique sliding vane designs, these positive displacement rotary pumps offer the best combined characteristics of sustained high level performance, energy efficiency, trouble-free operation and low maintenance cost.

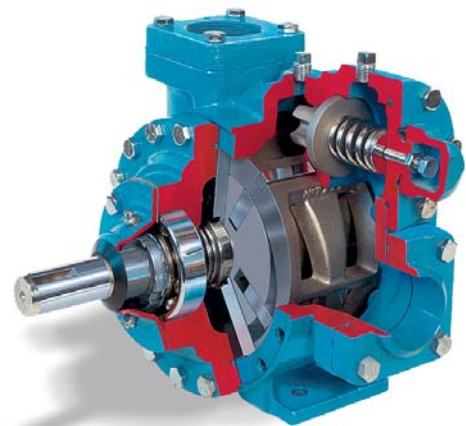

XLW Pump



How Blackmer's sliding vane action works

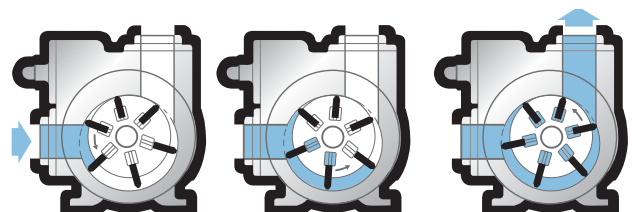



XLW Series Sliding Vane Pump

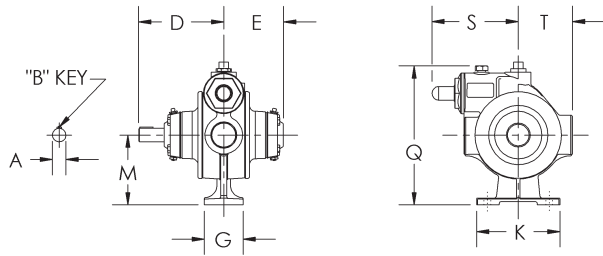

X(R)LW1.25/XLW1.5

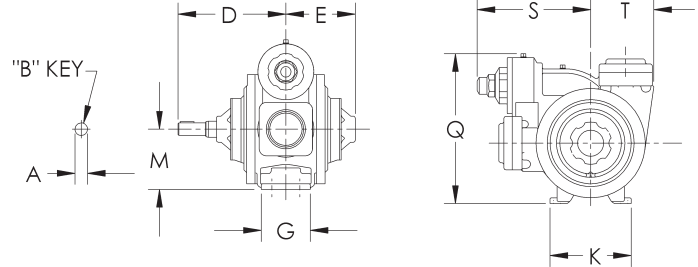

XLW2/XLW3

Dimensions

Pump Model		A	B	D	E	G	K	M	Q	S	T	Approx. WT.
XRLW1.25 XLW1.25 XLW1.5	in.	7/8	3/16	5 1/2	3 3/8	2 1/2	5 1/2	4 1/2	9 3/8	5 3/8	3 1/2	30 lbs
	mm	22	5	140	98	64	140	114	232	143	89	14 kg
XLW2	in.	1 1/8	1/4	8	5 7/16	3 3/8	6 1/2	4	10	6 3/8	4 3/16	85 lbs
	mm	29	6	203	138	92	165	102	254	175	106	39 kg
XLW3	in.	1 1/8	1/4	9 3/8	6 5/16	4 3/8	7 1/4	5 3/8	13 3/8	10 1/4	5 3/8	160 lbs
	mm	29	6	244	160	111	184	137	340	260	143	73 kg

Maximum Operating Limits

Pump Model	Nominal Flow Rate			Pump Speed	Viscosity		Differential Pressure		Working Pressure		Temperature	
	gpm	L/min	m ³ /hr	rpm	ssu	cSt	psi	bar	psi	bar	°F	°C
XRLW 1.25	8.5	32	1.9	870	50,000	10,625	150	10.34	350	24.13	300	148
XLW 1.25	11.5	43.5	2.6	870	30,000	6,375	150	10.34	350	24.13	300	148
XLW 1.5	17	64	3.8	870	20,000	4,250	150	10.34	350	24.13	300	148
XLW 2	40	151	9.1	350	75,000	15,750	150	10.34	350	24.13	300	148
XLW 3	85	322	19.3	350	75,000	15,750	150	10.34	350	24.13	300	148

Companion Flanges

Pump Model	Standard	Optional
XRLW1.25 XLW1.25	1 1/4" NPT Tapped Ports	N/A
XLW1.5	1 1/2" NPT Tapped Ports	N/A
XLW2	2" NPT	2" ANSI, DIN & Weld
XLW3	3" NPT	3" ANSI, DIN & Weld

Sales Information and Equipment Application Assistance

Blackmer has a world wide distribution network to assist you in specifying any of our family of pumps, compressors and other equipment for your application.

For more information or to find the distributor nearest you, please contact us or visit our web site.



Distributed by:

