

BLACKMER PUMP PARTS LIST

MODELS: PLW(J)2B, PLW(J)3B

DISCONTINUED MODELS: PLW(J)2A, PLW(J)3A

NOTE: "B" model suffix indicates Viton replaces Buna-N as the standard elastomer.
(See Instructions 185/MM for Installation, Operation and Maintenance)

963911

PARTS LIST NO. 185/M7

Section	100
Effective	June 1995
Replaces	April 1990

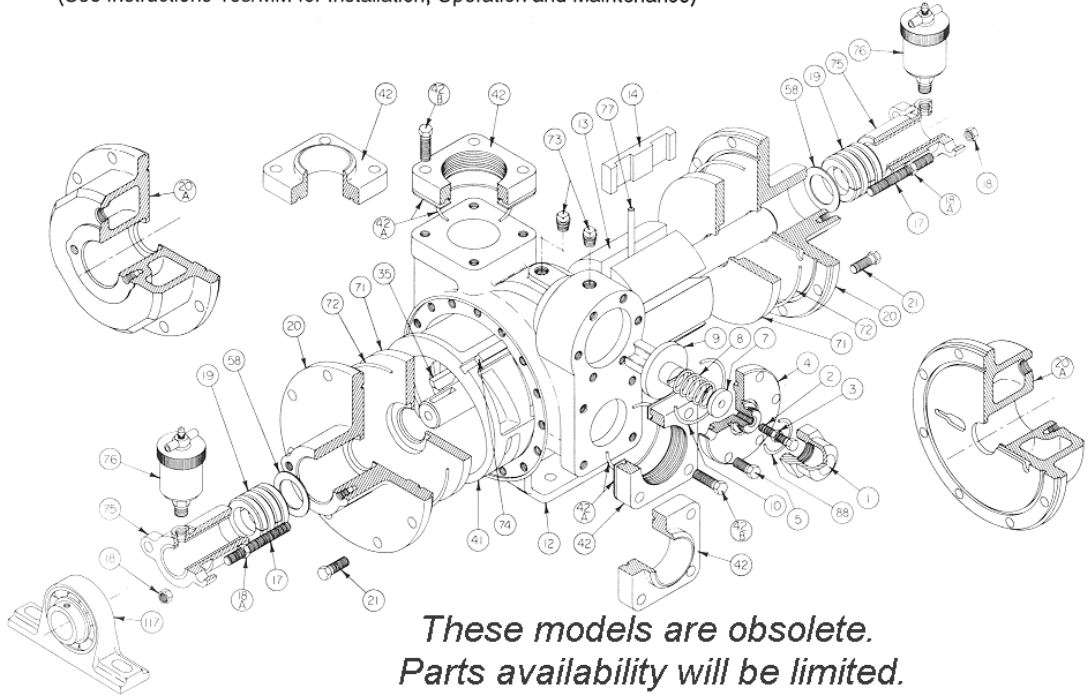

REF. NO.	PART NAME	PARTS PER PUMP	SIZE 2 PART NO.	SIZE 3 PART NO.	REF. NO.	PART NAME	PARTS PER PUMP	SIZE 2 PART NO.	SIZE 3 PART NO.		
1	Cap - Relief Valve (R/V)	1	414402	414402	20A	Jacketed Head (Std. - PLWJ)	2	034435	035135		
2	Adjusting Screw - R/V	1	433905	431808	21	Capscrews - Head	16 - 20	920331	920351		
3	Locknut - Adjusting Screw	1	922923	922923		Capscrews - Jacketed Head		920331	920369		
4	Cover - R/V	1	414408	415112	35	Key - Shaft	1	909130	909135		
5	Capscrew - R/V Cover	6	920316	920331	41	Liner	1	183913	185116		
7	Spring Guide - R/V	1	424401	423955	42	Flange - NPT	2	654401	655112		
8	Spring - R/V (35 - 50 psi) (Std. - PLW)	1	471420	471608	42A	Flange - Weld	2	654405	655102		
	Spring - R/V (51 - 75 psi)		471425	471612		O-Ring - Flange (Viton) (Std.)		702086#	711931#		
	Spring - R/V (76 - 110 psi)*		471428	471621		O-Ring - Flange (Teflon)		702078#	702080#		
	SS Spring - R/V (35 - 50 psi) (Std. - PLWJ)		471418	471610		42B		Capscrew - NPT Flange	8	920384	920547
	SS Spring - R/V (51 - 75 psi)		471427	471632				Capscrew - Weld Flange	8	920351	920510
SS Spring - R/V (76 - 110 psi)*	471429	471615									
9	Valve - R/V	1	454405	455129	58	Packing Washer	4	353907	355107		
10	O-Ring - R/V Cover (Viton) (Std.)	1			71	Disc	2	063980	065181		
			O-Ring - R/V Cover (Teflon)	702077#	702079#	72	O-Ring - Head (Viton) (Std.)	2	702045#	711938	
			O-Ring - Head (Teflon)				O-Ring - Head (Teflon)		702081#	702082#	
12	Casing	1	014405	015127	73	Gage Plug	2 - 4	908195	908195		
13	EC Rotor & Shaft Assy. (Std.)	1	264427	265227	74	Key - Liner	1	184407	185191		
	EC Rotor & Shaft Assy. (V-Belt Length)		264428	265228							
14	Vane - Hardened Iron	6	093930	095127	75	Gland Bearing (Std. - PLW)	2	143909	145109		
	Vane - EC Hard. Iron (Std.)		093931	095129		Gland Bearing (Std. - PLWJ)		143910	145110		
	Vane - Laminate		091427	095109	76	Automatic Lubricator	2	317880	317880		
	Vane - EC Laminate		091429	095107	77	Push Rod	3	123905	125105		
	Vane - Bronze		093922	095116							
	Vane - EC Bronze		093924	095120	88	O-Ring - R/V Cap (Viton) (Std.)	1	701979#	701979#		
17	Stud - Gland	4	921475	921475		O-Ring - R/V Cap (Teflon)		702075#	702075#		
18	Stud Nut - Gland	4	922428	922428	117	Pillow Block	1	903737	903736		
18A	Removal Nut - Gland	4	922949	922949							
19	Packing Set	2	323976	325176							
20	Head (Std. - PLW)	2	034434	035134							

* R/V spring range (p/n 471428 & 471429) for 2-inch models is 76 - 90 psi.
SS = Stainless steel spring for temperatures over 300°F (149°C).

Recommended spare parts.

EC = Extra Clearance